

# AltRider Crash Bars for the Triumph Tiger Explorer 1200

## INSTALLATION INSTRUCTIONS

Dear Rider,  
Thank you for choosing AltRider! Whether a seasoned world adventurer or a first time ADV-Newbie, we welcome you to the AltRider experience. You can install your new product with the utmost confidence. AltRider designs, tests, and manufactures all of its products here in the United States. We are proud to do what we do, and honored to present to you the product of our labors.

Enjoy it, show it off, and most of all, RIDE IT!

Venture On,  
Jeremy LeBreton



### Triumph Tiger Explorer 1200 Crash Bars

Package Contents:  
- left and right engine bars  
- Instructions  
- Hardware kit

---

## AltRider LLC

### Global

mailing: 4000 Aurora Ave N Ste 100  
Seattle, WA 98103 USA  
phone: 206-922-3618  
email: info@altrider.com  
web: www.altrider.com

### Europe

mailing: Oude Middenweg 231-M  
2491 AG DEN HAAG  
Netherlands  
email: info@altrider.eu  
web: www.altrider.eu

Rev 0



## Kit:

- ① Left and Right crash bars
- ② (2) M8 x 1.25 x 30 mm socket head cap bolt
- ③ (2) M8 x 1.25 x 25 mm socket head cap bolt
- ④ (4) M8 washers
- ⑤ T40 driver
- ⑥ T55 driver

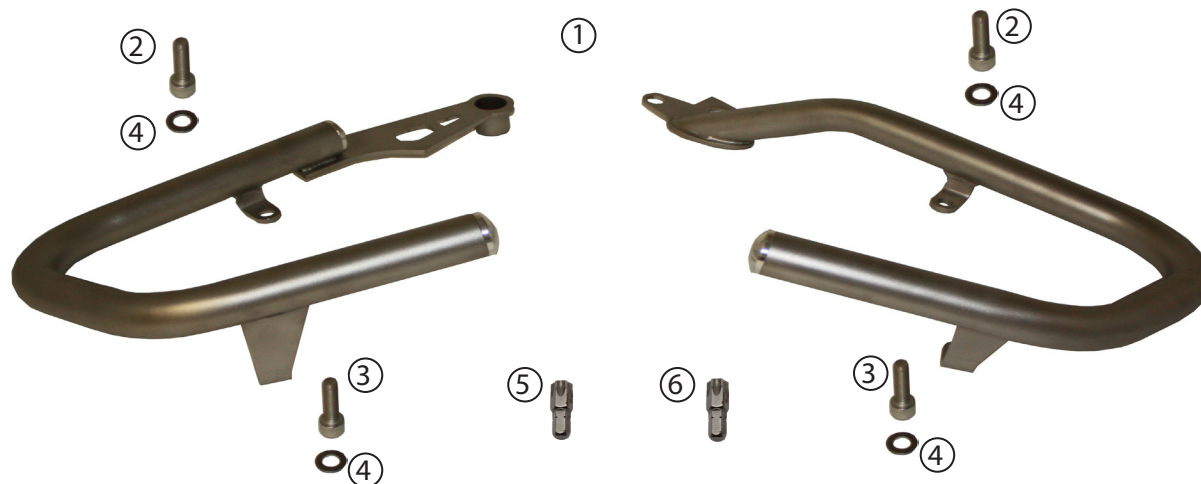

## Recommended tools:

- ① 1/2" ratchet
- ② 1/2" extension
- ③ 1/4" ratchet
- ④ 1/4" extension
- ⑤ M6 allen driver
- ⑥ 8 mm socket
- ⑦ 12 mm socket
- ⑧ 14 mm socket
- ⑨ 17 mm socket
- ⑩ Thread locker
- ⑪ Magnetic hardware tray (not shown)





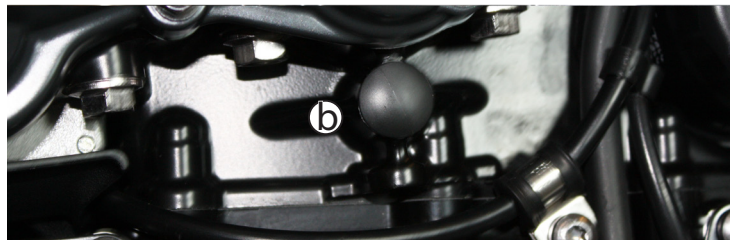
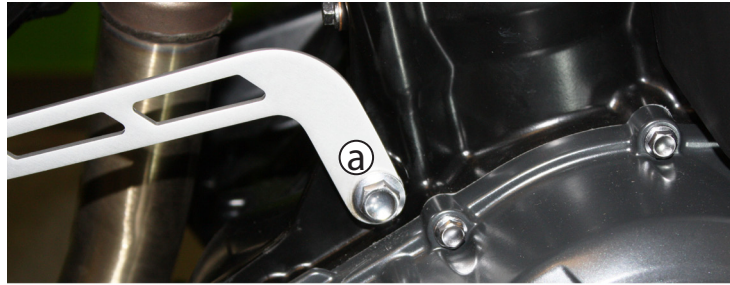

- ① Using a 12mm socket, remove the two (a) M8 radiator mount bolts from either side. Also unthread the (b) small plastic plugs from the engine, there is one on each side for the lower mount.

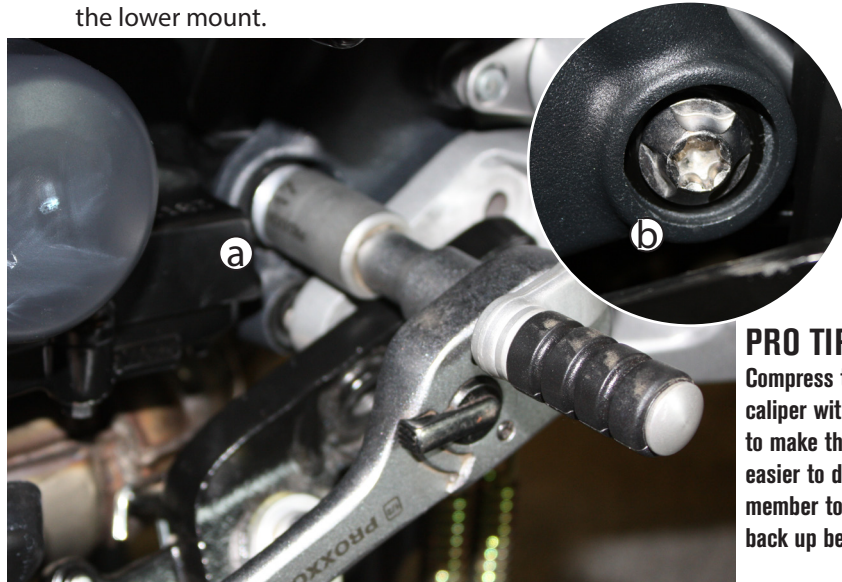

**PRO TIP:**  
Compress the brake caliper with your hand to make the brake lever easier to depress. Remember to pump brake back up before riding.

- ③ Using a 17 mm socket, remove the (a) nut from the 12 mm engine bolt. You may need to hold the (b) bolt head end with the provided T55 driver. With nut removed slide the bolt out of the engine. You can drive the bolt out with a 1/4" extension if there is resistance.

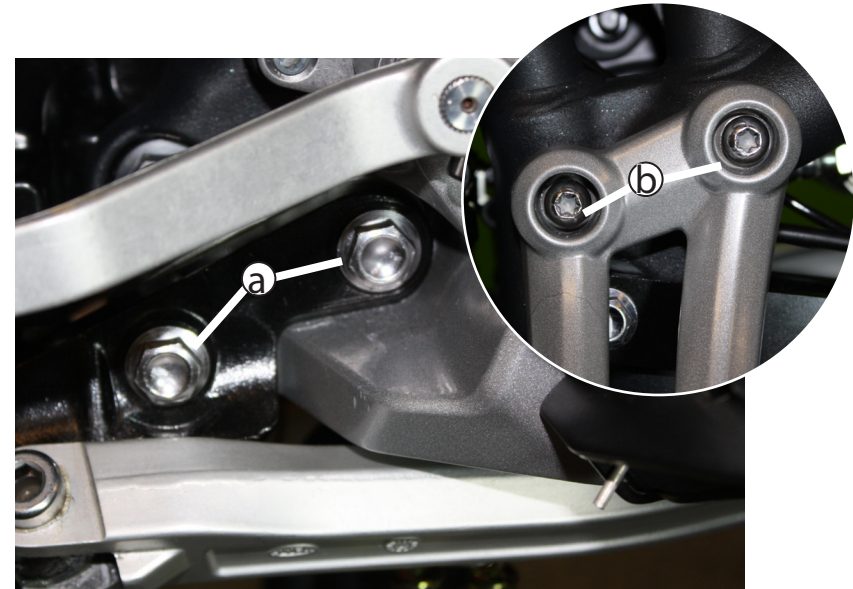

- ② With bike on center stand, remove the (a) (2) M10 kick stand bolts using a 12mm socket. Loosen the (b) (2) T40 foot peg bracket bolts halfway, this provides access to next nut. When this assembly is loose be cautious of the vulnerable side stand switch.

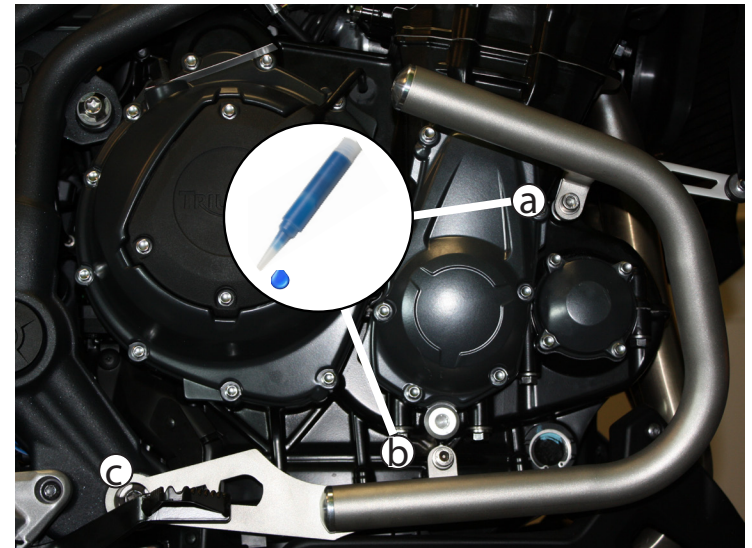

- ④ Install the right side crash bar by starting with the (a) M8 x 30 mm fastener and washer to the radiator mount and following with the (b) M8 x 25 mm fastener and washer using thread locker. Complete right side by re-installing the 12 mm engine bolt. Do not completely tighten any fasteners just yet. Use 1/4" driver to push the 12 mm engine bolt if needed.



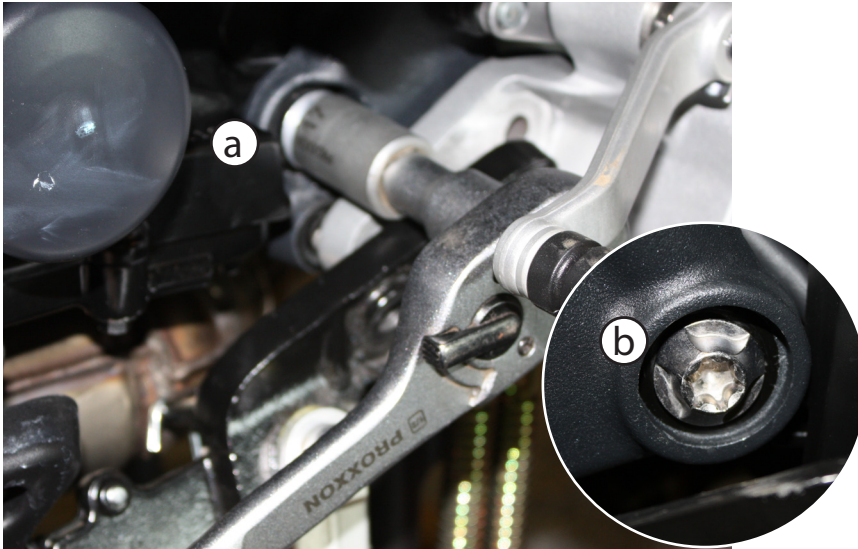

- ⑤ On the riders left side, re-install the engine bolt (a) nut using a 17mm socket. Tighten this to 105 nm of torque. You may need to use the supplied T55 driver to keep the (b) bolt from spinning.

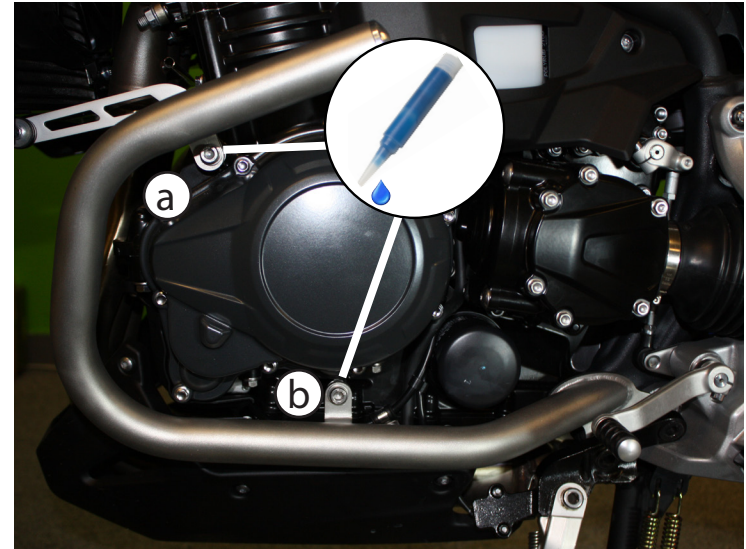

- ⑥ With the side stand still removed, install the left side bar. Start with the (a) M8 x 30 mm bolt and washer that attaches to radiator mount. Next install the (b) M8 x 25 mm lower mount bolt with washer and thread locker for both bolts. Do not tighten either bolt completely.

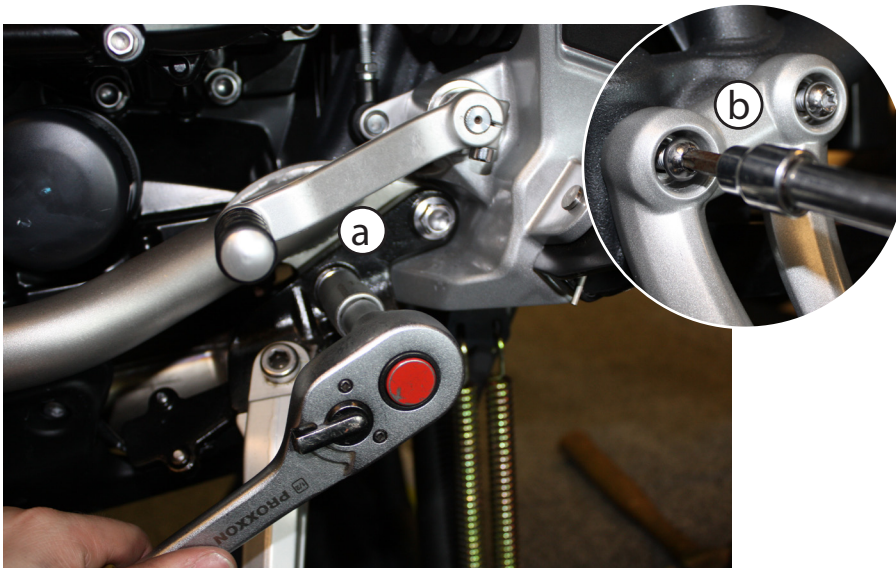

- ⑦ Stack the side stand mount casting on top of bar and then begin threading the (a) (2) OEM M10 side stand bolts back into place. Do not tighten all of the way. Next tighten the (b) (2) T45 peg mount bolts. Now you can tighten the (4) M8 crash bar fasteners to 18nm of torque and then the (2) M10 side stand bolts to 70nm of torque.

## CONGRATULATIONS!

**You've completed your installation. If at any point you have questions about your installation or have any feed back for us, we'd love to hear it. A downloadable version of these instructions can be found at our web site. [www.AltRider.com](http://www.AltRider.com)**

**After 5 hours of riding, or 100 miles, check all the fasteners on the assembly to ensure they are tightened to spec.**

### Global Office:

**email: info@AltRider.com**  
**phone: +1 206-922-3618**  
**address: 4000 Aurora Ave N**  
**Ste 100**  
**Seattle, WA 98103**



### Europe Office:

**email: info@AltRider.eu**  
**address: Oude Middenweg 231-M**  
**2491 AG DEN HAAG**  
**Netherlands**

#### TERMS OF USE, WARRANTY AND LIABILITY WAIVER

AltRider LLC, a Washington company, having its principal place of business in Seattle, WA ("AltRider") offers its motorcycle accessories (the "Product") with the terms, conditions and notices as follows:

##### Terms of Use

This Product is offered to you conditioned upon your acceptance without modification of the terms, conditions, and notices contained herein. Installation and/or use of this product implies acceptance of all such terms, conditions, and notices. If you do not agree to these terms, do not buy the Product. If you have already bought the Product and do not agree to these terms, return this Product promptly including the packaging and all written materials, to AltRider.

##### Limitation of Liability and Warranty Disclaimer

You may return your merchandise for a full refund or exchange, less any original or return shipping fees under these conditions:

1. Only if the merchandise is in 100% factory condition. Original manufacturer's packaging and same condition as sold – original boxes, packaging material, instructions, documentation, parts, and attached tags.
2. Only unused, unscratched, uninstalled, undamaged merchandise will be accepted. Do not install equipment until you are sure you want to keep it. Package items carefully in protective materials before returning them. Never ship an item in its original manufacturers packaging – it will arrive damaged. Please use a postal box or other adequate packaging to ensure your return or exchange is not damaged on the way back to AltRider.com.

To read more about our exchanges and returns policy, on the web, navigate to [www.alt rider.com/index.php/symfony/exchangesAndReturns](http://www.alt rider.com/index.php/symfony/exchangesAndReturns)

Excepting the warranties stated in the preceding paragraph, AltRider hereby disclaims all other warranties and conditions with regard to the Product including all implied warranties and conditions of merchantability and fitness for a particular purpose. There are no warranties which extend beyond the description on the face hereof. AltRider does not warrant against damages or defects arising out of use or installation of the Product. Installation instructions are provided for your convenience. AltRider is not responsible for any damages arising out of the installation, improper or otherwise, of the Product. No warranty of any kind, expressed or implied, is made regarding the safety of this Product.

To the extent allowed by law, AltRider shall not be held liable for any direct, indirect, punitive, incidental, special or consequential damages arising out of, or connected with, the use or misuse of this Product. Buyer assumes all risks and liability arising from use of this Product.

##### Entire Agreement

This document states the entire obligation of AltRider with respect to the Product. If any part of this agreement is determined to be void, invalid, unenforceable or illegal, including, but not limited to the warranty disclaimers and liability limitations set forth above, then the remainder of the agreement shall remain in full force and effect.

##### Applicable Law

This agreement is governed by the laws of Washington, USA. You hereby consent to the exclusive jurisdiction and venue of the courts of Washington, USA, in all disputes arising out of or relating to the use of this product.

